

# SINGLE USE 5 1/2" MOLDED PULP VOID GRASSED SYSTEM

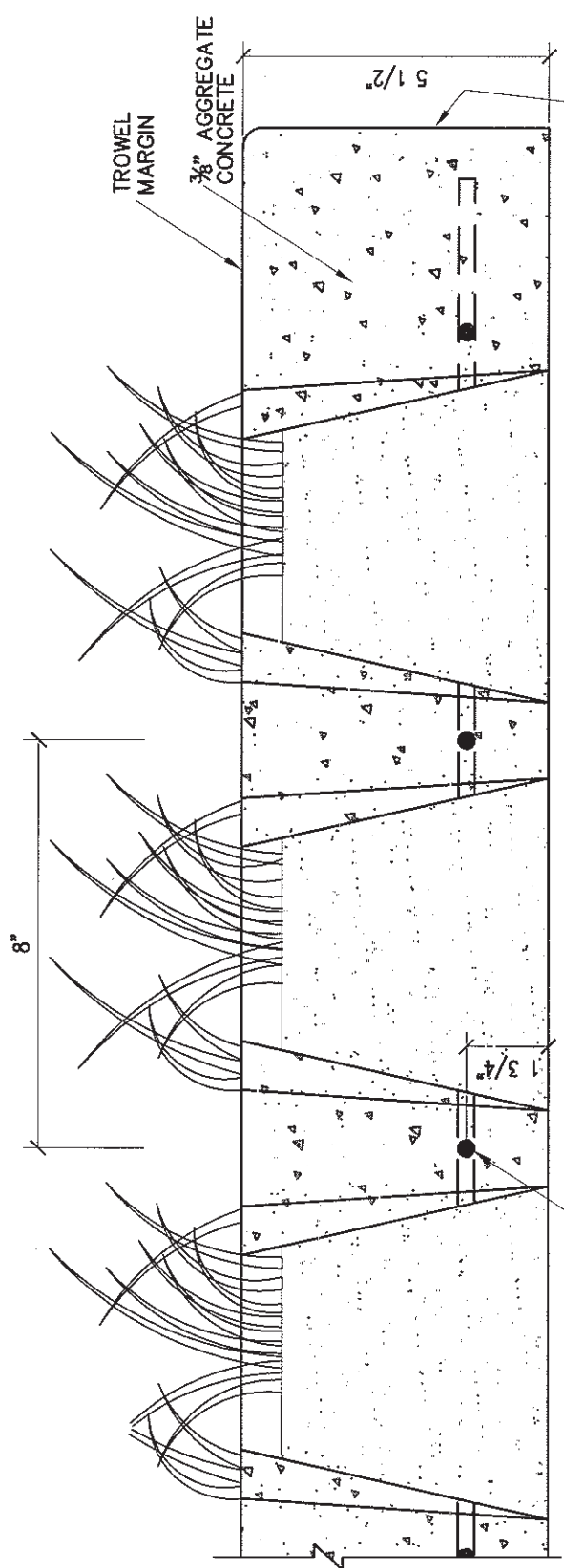

CONSULT THE TECHNICAL BULLETIN FOR INFORMATION ON REQUIRED REINFORCEMENT.

STANDARD EDGE DETAIL  
EXPANSION JOINT AT MAX. 50 FT.  
CENTERS TO BE BITUMEN  
IMPREGNATED FIBER BOARD

1" CLEAN ASTM C-33 SAND  
2" - 6" MIN GRANULAR  
SUB-BASE 3/4" MIN. DIA. AGGREGATE

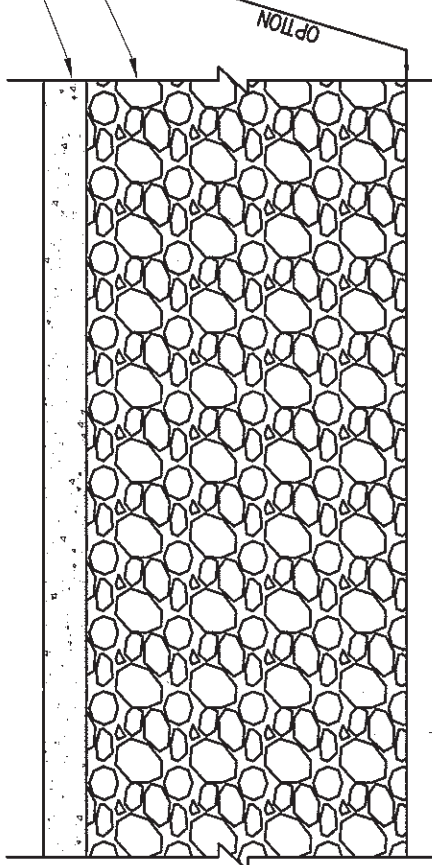

CROSS SECTION OF BASE

MIN 6" OPTIONAL DRAINAGE BLANKET OF CLEAN  
CRUSHED STONE OR CONCRETE WITH NON-WOVEN  
GEO-TEXTILE TO FORMATION AND NEEDLE-PUNCHED  
GEO-TEXTILE COVER LAID LEVEL FOR  
SUB-GRADE FILTRATION OR FOR  
RAINWATER HARVESTING